

# INSTRUCTIONS



## Accessories

- Device with bag and neck strap
- Adjustable chest and abdominal strap (long) with two integrated thorax sensors and one abdominal sensor
- Oxygen saturation sensor with plugged-in connection cable and Velcro strap (short) for fixation to the wrist
- Nose sensor with plugged-in connection cable
- Order form, patient record and instructions
- Red closure clip for the return

## Return

After completing the recording, please return the device with plugged-in cables, straps, Velcro strap, thorax and abdomen sensors, oxygen saturation sensor, order form and patient record. Viollier will cover the shipping costs.

- By customer service – return to practice
- By DPD – drop off at a pickup parcelshop → [dpgroup.com/ch/mydspd/parcel-shops](https://dpgroup.com/ch/mydspd/parcel-shops)
- By mail

Please note the following instructions for the return of the box:

- Remove label from window
- Slide the appropriate return label (in the box) into the window  
→ **Viollier AG address is visible**
- Close box with red clip

herzlungenpraxis.ch



Polygraphy



# Important information

**Do not test start the device → The device cannot be switched off again.**

- Remove nail polish, gel nails and fingernail attachments before the examination.
- Do not put the oxygen saturation sensor on the same limb as the 24h blood pressure device cuff if these two devices are worn at the same time.
- Mount and start the device before going to bed.
- Recording time max. 8 hours, suitable for patients weighing 50 kg and over.
- Do not use in the vicinity of CT, MRI and X-rays.
- Mobile phones, strong electromagnetic sources and electric blankets can affect the quality of the recording.

## Patient record

Please inform the patient about the diagnostic importance of filling out the patient record correctly and completely. **Please use a black ballpoint pen, not a pencil.**

**Note start and end of recording including date and time.**

## Identification and analysis

- Patient's personal details
- The date and exact start time of the recording, entered by you
- The device and finger sensor numbers entered by Viollier on the order form

Geräte-Nr. **010** Finger sensor-Nr. **015**

**Please use the enclosed order form only, as this already has your address on it.**

# Attaching the device

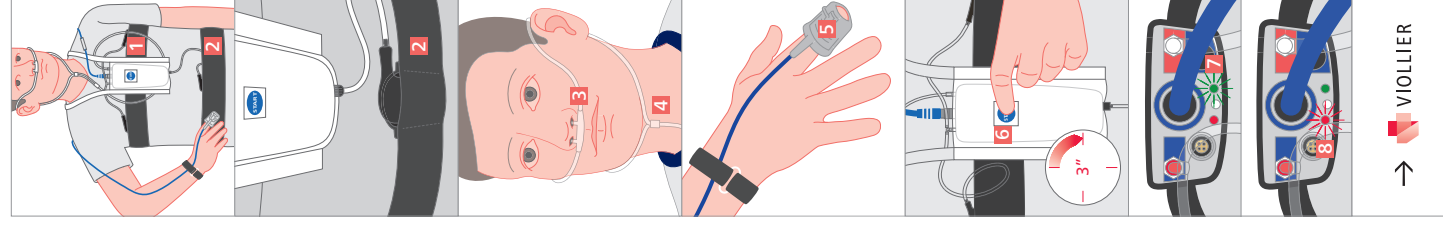

## Mounting the device before going to bed

- Do not wear the device and the chest and waist straps directly on the skin.
- Pull the neck strap and the device over the head.
- Fix the device centrally at sternum height using the chest strap **1** → **at the level of the nipples for men and on the upper part of the chest for women.**
- Use the waist strap **2** to pull the abdomen sensor around the abdomen (at navel level). The pressure sensors must be on the inside of the strap.
- Tighten both straps, but not so much that breathing is restricted.
- Place the nasal sensor underneath the nose. Position the opening **3** at the nostrils.
- Feed the tubes behind the ears, pull the slide **4** up under the chin and adjust.

## Fitting the finger sensor

- Mount the oxygen saturation sensor on your finger with the fingernail symbol facing upward. Pull the finger sensor over the finger until the fingertip is visible.
- The finger sensor **5** may be switched from one finger to another during the night.
- **Suitable fingers: index, middle and ring fingers** (without nail polish, gel nails or fingernail attachments)
- Fix the sensor cable to the wrist with the Velcro strap.
- If the finger sensor comes off at night, please reattach it.

## Starting the device

- Press the **front blue start button 6** for 3 seconds.
- During recording, the **green light 7** flashes every four seconds. If a **red light 8** appears next to it, then the finger sensor is not correctly positioned → please correct this.
- In the morning dismount the device and return. **Device switches off automatically after 8 hours.**